



# FITTING INSTRUCTIONS

Part Number: **4140135**

Product Description: **SUPPLEMENTARY BRACE KIT | 22+ RANGER D/C CANOPY INSTALL**

ARB 4x4 Accessories Corporate Head Office

[www.arb.com.au](http://www.arb.com.au)

42-44 Garden St  
Kilsyth, Victoria  
AUSTRALIA 3137

Tel: +61 (3) 9761 6622  
Fax: +61 (3) 9761 6807

Australian enquiries  
North & South American enquiries  
Other international enquiries

sales@arb.com.au  
sales@arbusa.com  
exports@arb.com.au

PARTS LISTING			TOOLS REQUIRED	
PART NO.	QTY	DESCRIPTION	PHILLIPS HEAD SCREWDRIVER	
180302	2	CABLE TIE BLACK	PISTOL DRILL	
3195597R/L	1R 1L	PLATE NUT SUITS J BRACE	HAMMER	
4584310	2	WASHER FLAT M6x25x2.8 ZNB480	Ø3mm PIN PUNCH	
4584424	6	WASHER FLAT M6x18x3 BTZP480	Ø6.5mm DRILL BIT	
5848531	2	PACKER UPRIGHT J BRACE	TORQUE WRENCH	
5848532	2	PACKER HORIZONTAL J BRACE	SOCKET SET	
6151173	2	NUT FLANGE M6 ZNB480	RIVET GUN	
6151213	2	BOLT HXHD M6x1.0x20 ZNB480		
6151596	2	P CLIP 19mm		
6151859	2	SCREW M6x16mm TORX PAN ZNB 480		
6151965	4	BOLT HXHD FL M10x1.5x30 ZNB480		
665003	4	RIVET POP 3/16 DIA 1.5 DOME x1"		
W715694	8	TRIM PIN 6.5-6.8 SCRIVET PLA 2.5-7		
W716351	8	TRIM PIN 9x0.8 SPL PLA		
4681786R/L	1R 1L	J BRACE SUITS RANGER		

## FITTING PROCEDURE

1. Raise vehicle on hoist and remove rear wheels.  
Steps **2 - 8** are to be completed on both sides of the vehicle for double cab models.  
Steps **2 - 8** do not need to be completed for extra cab (super cab) models, skip to step **9**.

RHS SHOWN

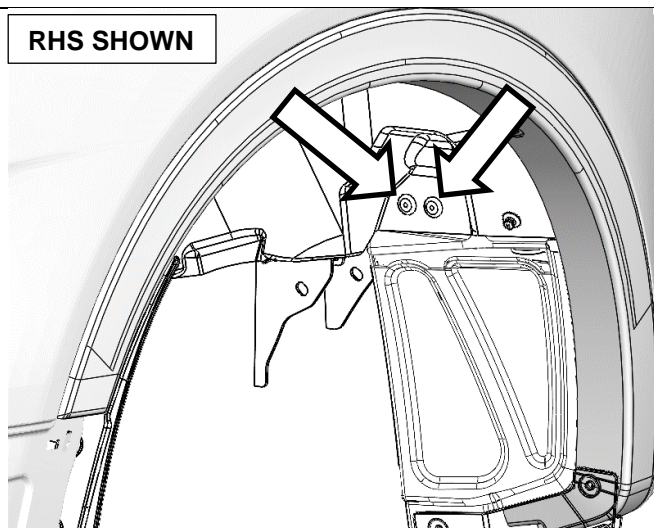

2. Punch out the cores of both black rivets located in the front of both rear wheel arches, using a Ø3mm pin punch & hammer.

RHS SHOWN

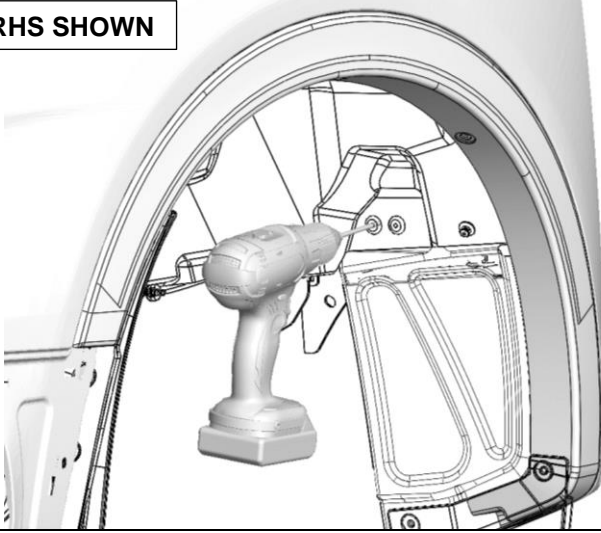

3. Drill out the remainder of the rivets with a  $\text{\O}6.5\text{mm}$  drill bit.

RHS SHOWN

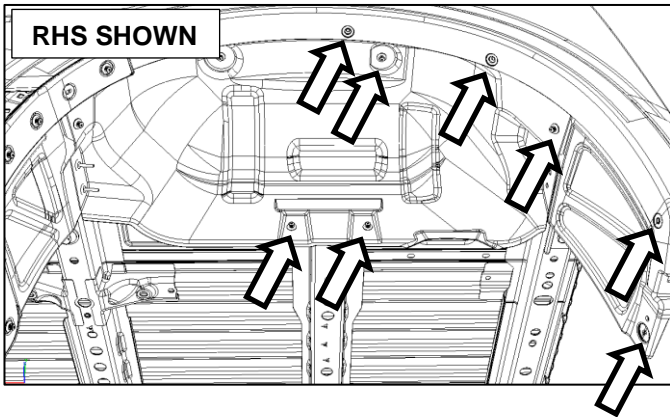

4. Remove 8 screws from the front half of each wheel arch liner by undoing the middle screw.



Some screws may be damaged on removal, some replacements have been provided.

RHS SHOWN

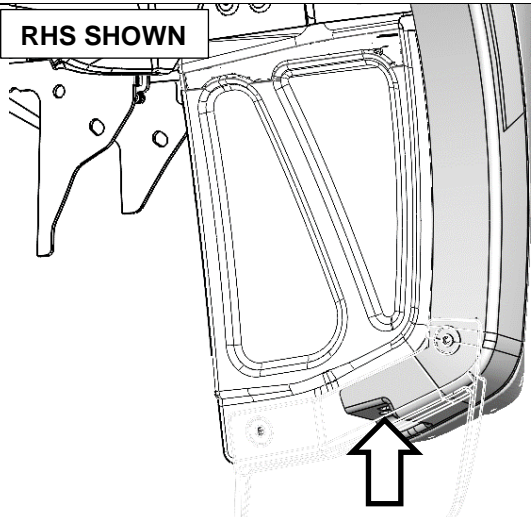

5. Remove the M6 fastener from the lower wheel arch moulding.

RHS SHOWN

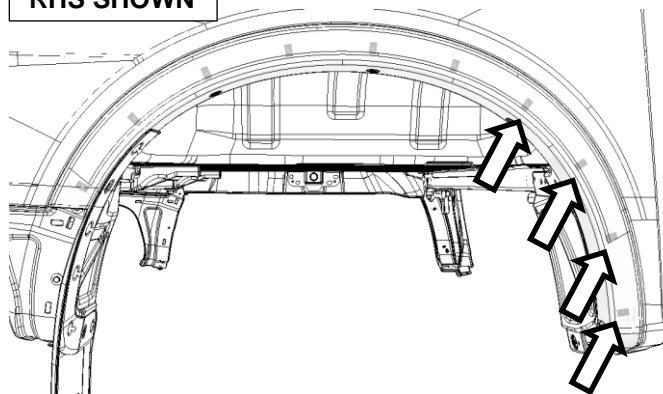

6. Carefully peel the front of the wheel arch flare back far enough to access the two M6 fasteners behind. Clip positions shown.

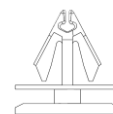

Some clips may be damaged during disassembly, some replacements have been provided.

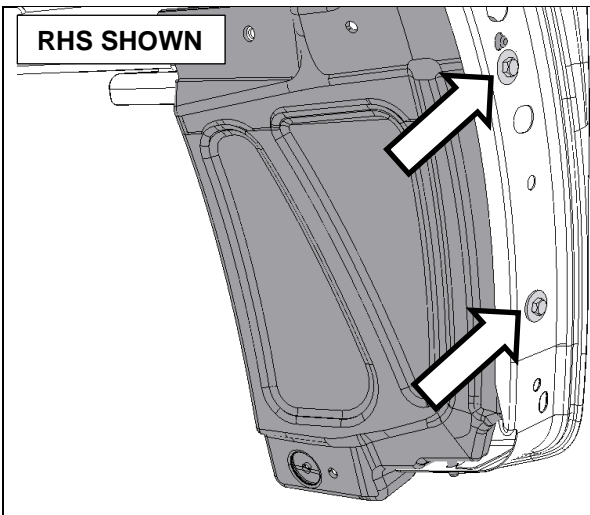

7. Remove M6 bolts and wheel arch mouldings from both sides.



8. Peel back wheel arch liner and secure with a ratchet strap or similar.

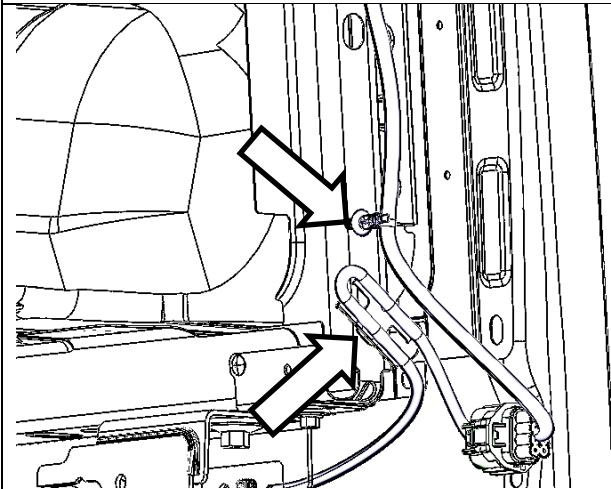

9. RHS Only.

Unclip wiring harness retainers in both places shown.

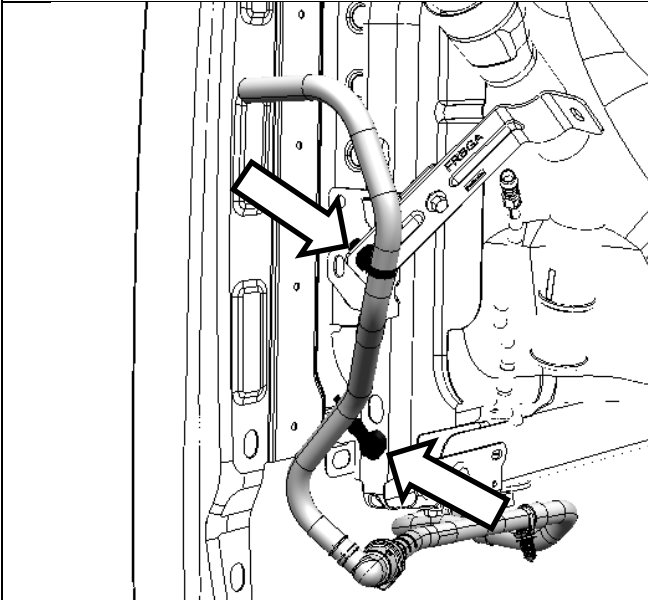

10. LHS Only.

Unclip fuel breather retainers in both places shown.

Steps 11 through to 20 are to be completed on both sides of the vehicle. Images depict RHS.

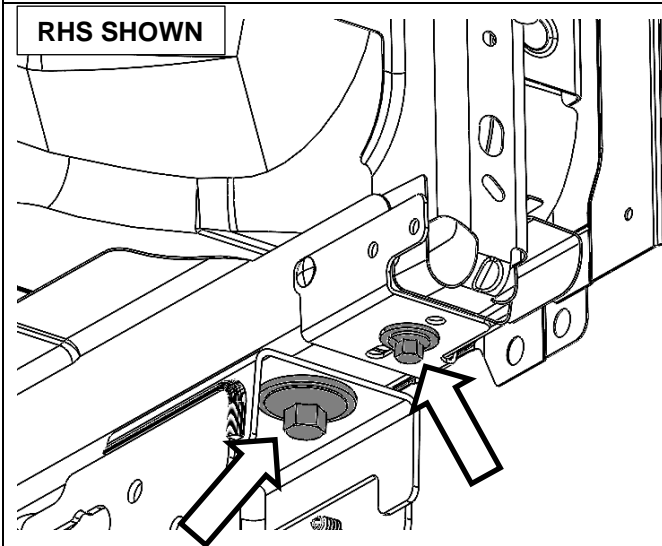

11. Remove M12 & M8 bolts from each side.

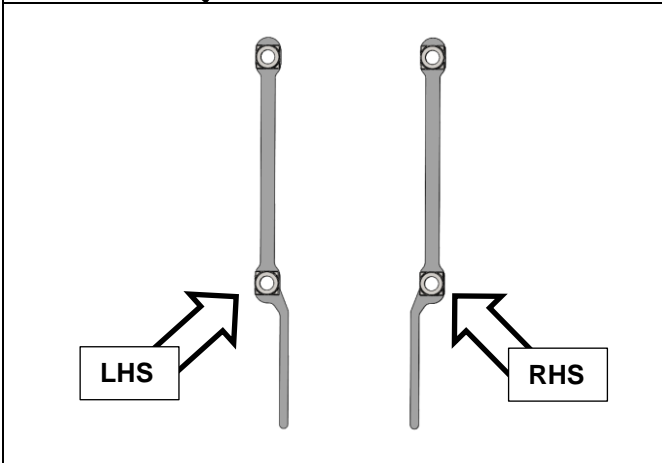

12. Identify the correct nut plate for each side of the vehicle.

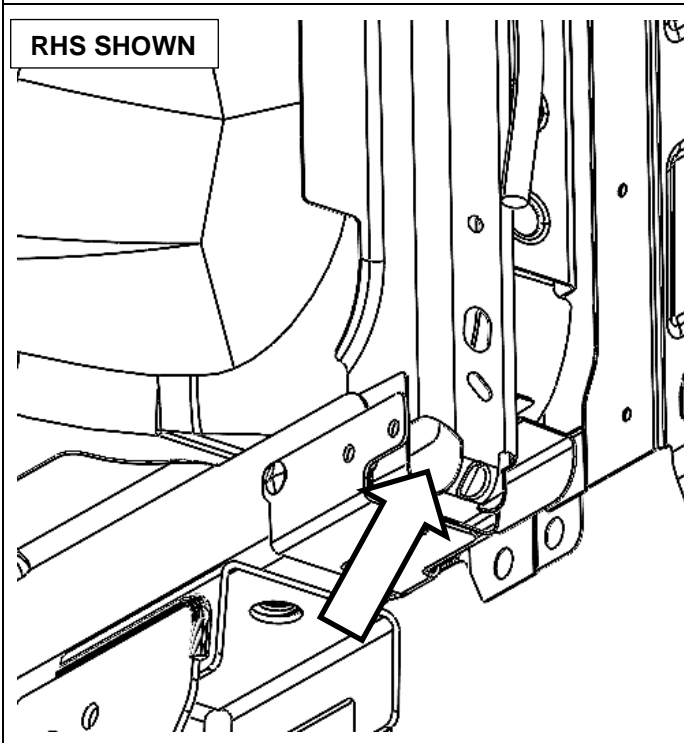

13. Feed the correct nut plate for each side into the vertical channel of the tub through the aperture shown.

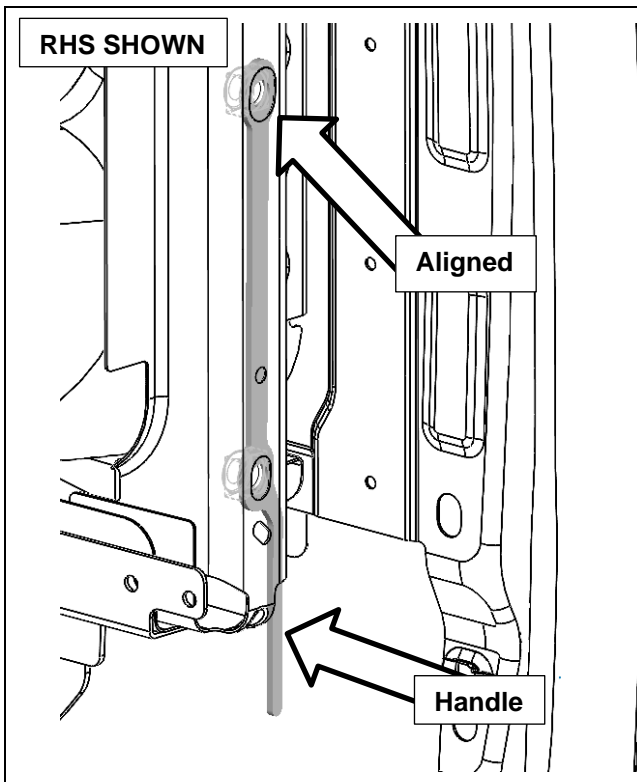

14. Position the nut plate inside the channel so that the nuts are aligned with the slots in the channel and the handle is protruding out the opposite aperture to the one mentioned in step 13.

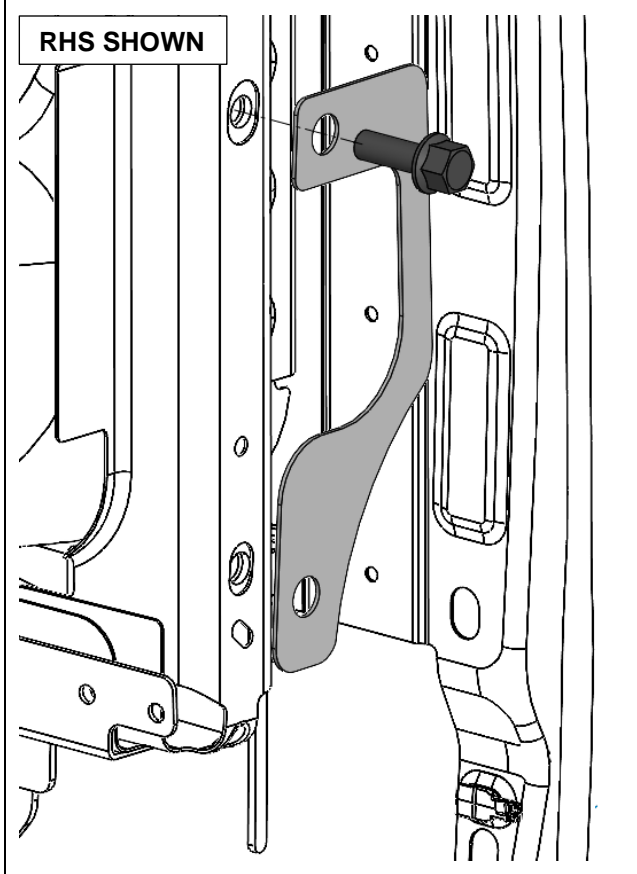

15. Loosely assemble an M10 Flange bolt through the vertical packing plate and into the top nut on the nut stick.

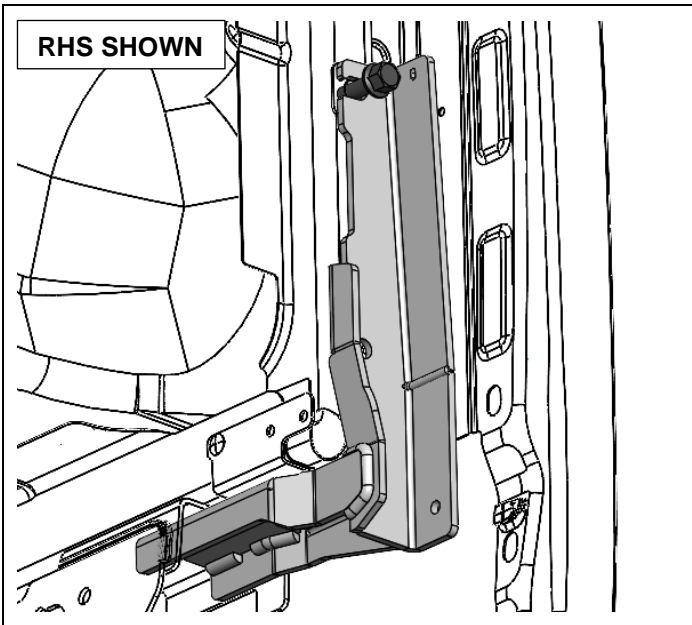

16. Hang J brace from the top bolt fitted in previous step.

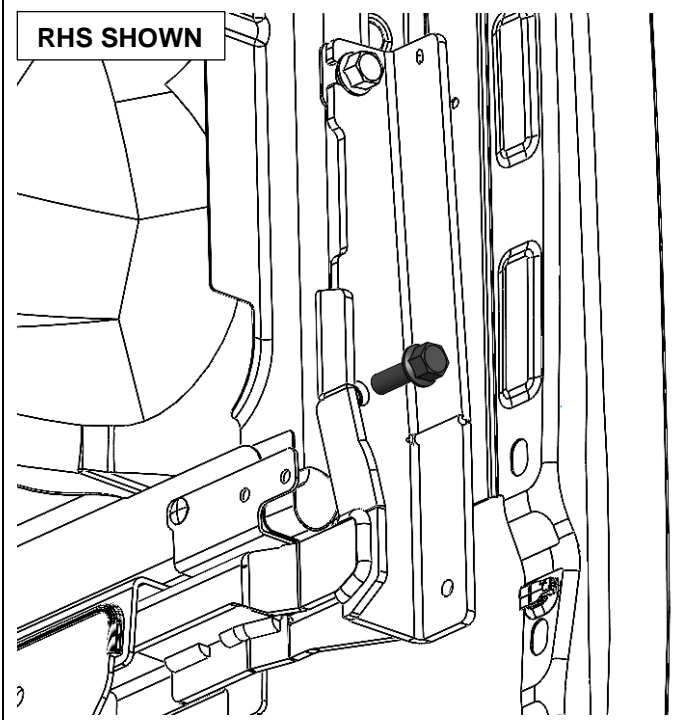

17. Loosely assemble second M10 Flange Bolt.

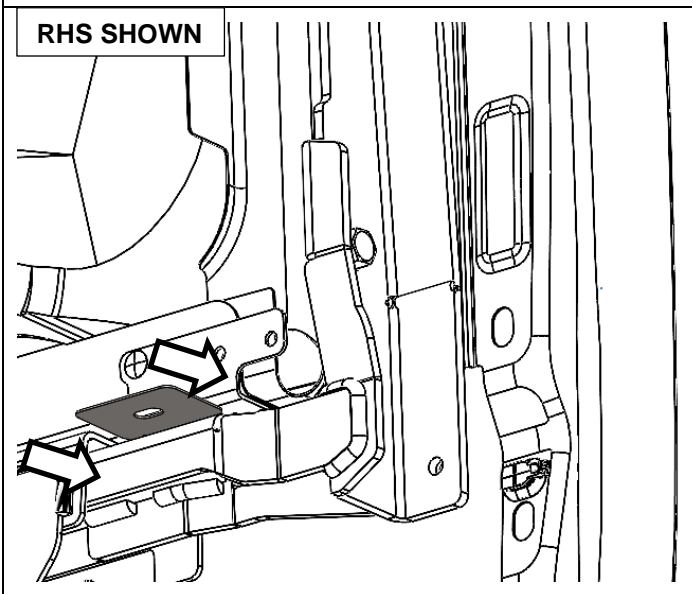

18. Slide the horizontal packing plate in between the J brace and the tub and align with the M8 thread in the tub.

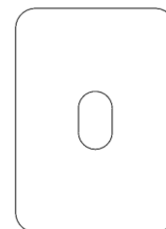

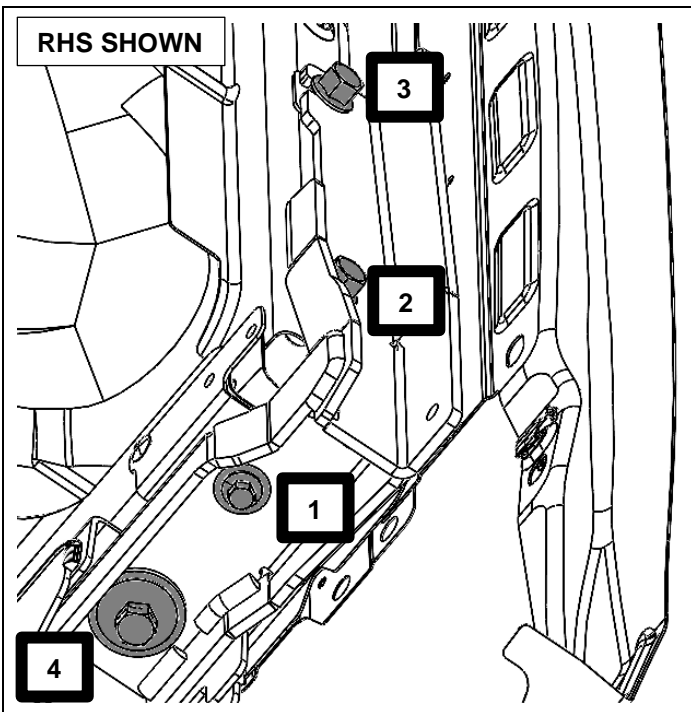



19. Refit original M12 & M8 Bolts removed in step 11.

20. Torque all bolts to specification in order shown.

 M8 - 25 Nm.

 M10 - 44 Nm.

 M12 - 125 Nm.

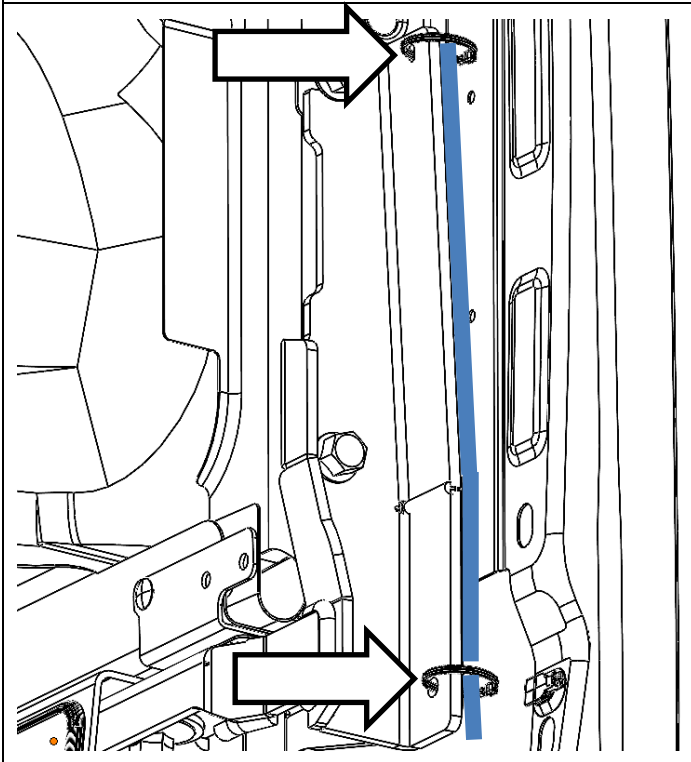

21. On the RHS only, secure wiring harness to the outside face of the J brace using the cable ties supplied.

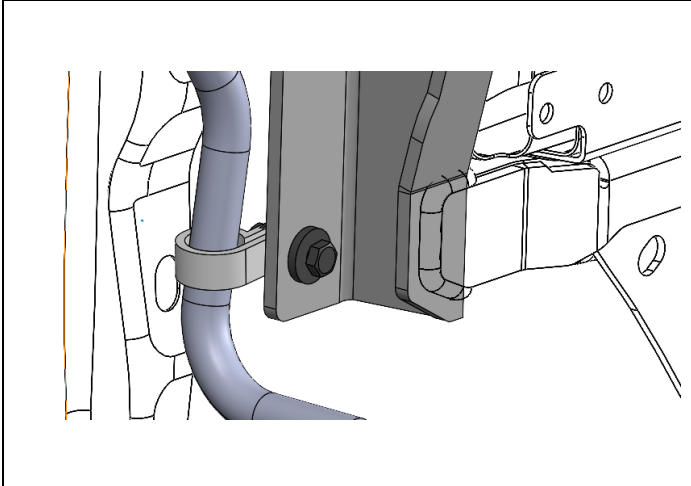

22. On the LHS only, secure fuel breather hose to the lower mounting hole on the outside face of the J brace using one 19mm P clip & M6 hardware provided.

(USE M6x18x3 Flat Washer & M6x20 HXHD Bolt)

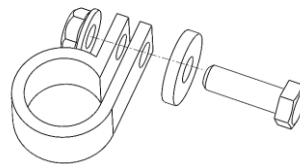

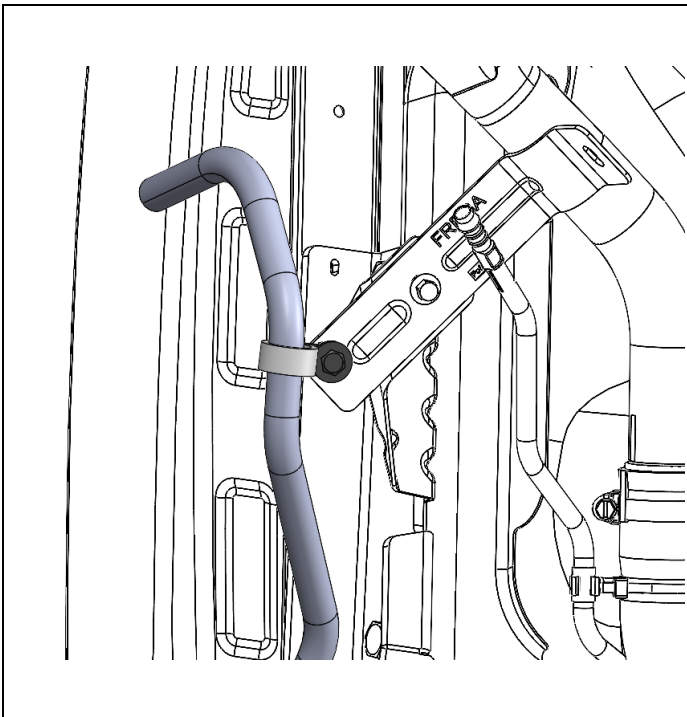

23. On the LHS only, secure fuel breather hose to the lower hole on the fuel filler neck bracket using one 19mm P clip & M6 hardware provided.

(USE M6x18x3 Flat Washer & M6x20 HXHD Bolt)

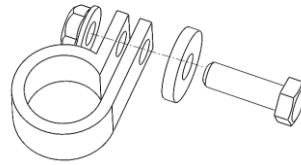

24. Torque both M6 Bolts to specification.

 M6 - 9 Nm.

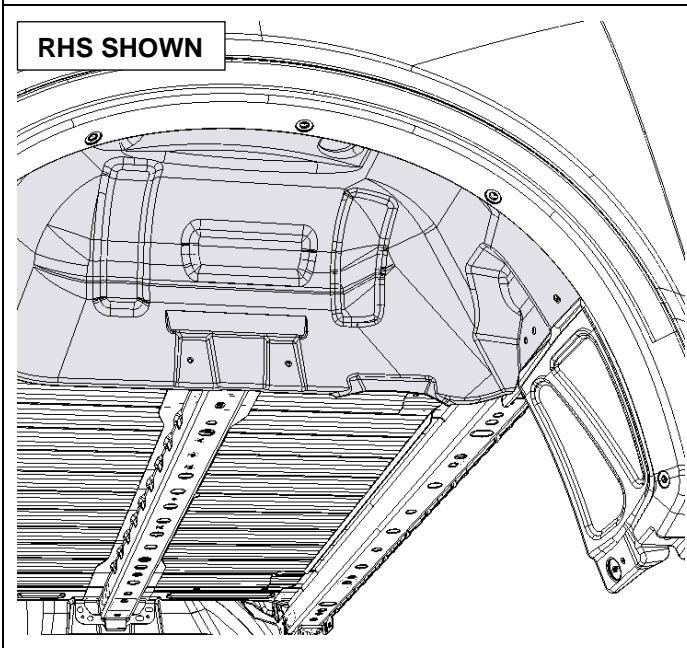

25. Reassemble wheel arch liner, flare and mouldings following steps 4-8 in reverse order. Replace any damaged clips or scrivets.

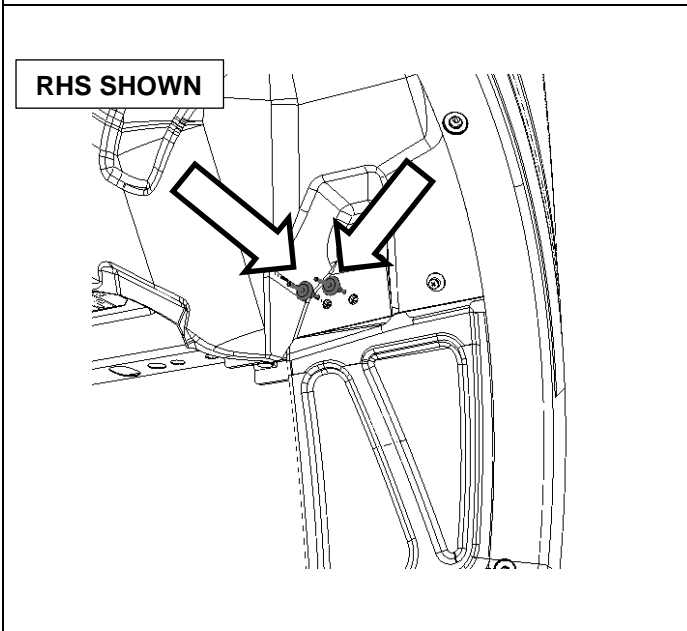
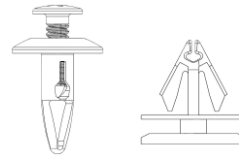

26. Install new rivets with M6x18x3 Flat washer under the head of the rivet.

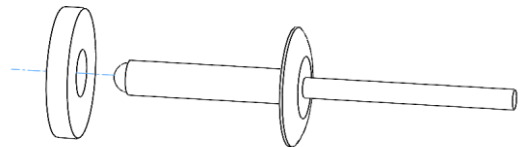
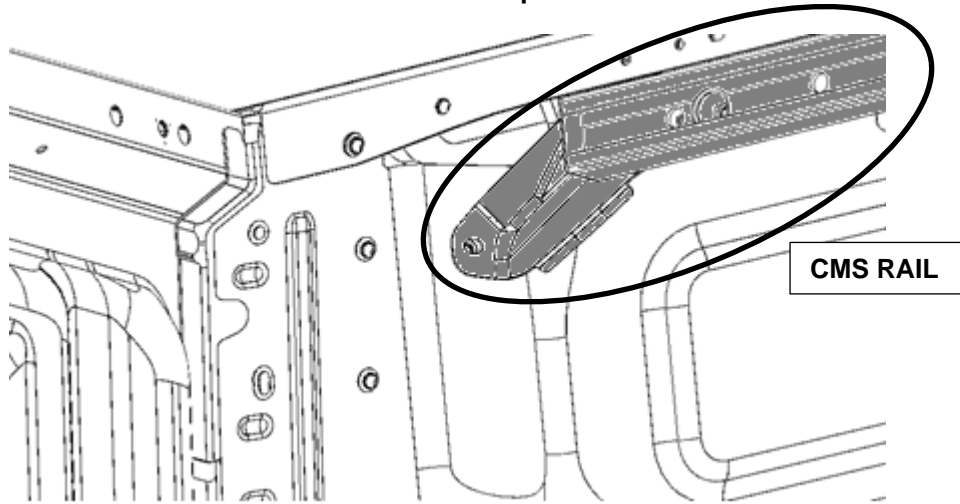
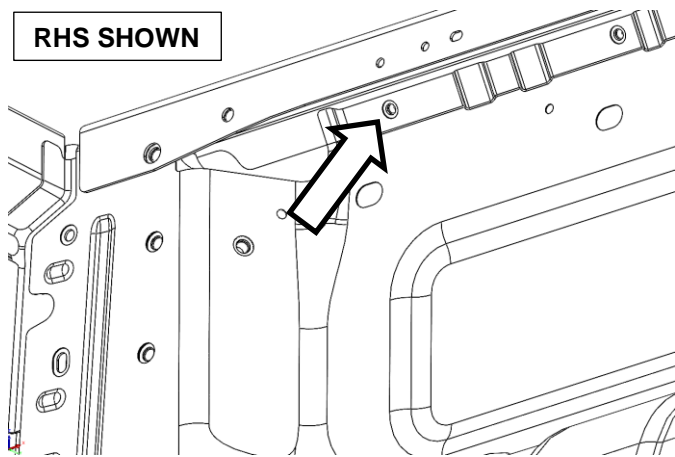



Image depicts CMS rail fitted in RH front corner of tub.  
When **NO** Cargo Management System accessory side rails are fitted to the vehicle's tub steps 27 & 28 need to be completed.



**RHS SHOWN**



27. Locate the captive nut in each front corner of the tub.

28. Assemble one M6x16 Pan Head Screw and 25mm OD Washer into the captive nut identified in the previous step. Repeat on opposite side.

Torque to specification.

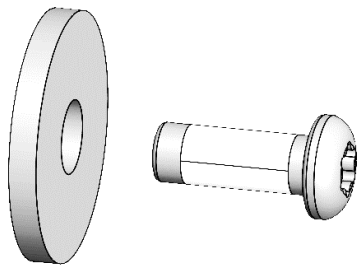

 M6 - 9 Nm.